

Installation Instructions

Pressure Sensor Replacement - 2005-2006 Tundra 4.7L

The factory pressure sensor is bolted onto the main Air Switching Valve that is located underneath the intake manifold. It cannot be changed without removing the intake. When bypassing the Secondary Air System with a Bypass Kit a damaged pressure sensor can be replaced without having to remove the intake manifold. This is accomplished by wiring the Pressure Sensor Replacement directly into the Engine Control Module in the passenger side dash. Mounting the pressure replacement under the dash at the ECM also protects the sensor from the environment and the vacuum tube nipple on the sensor can be left open. Since the bypass prevents the system from running the sensor only needs to read atmospheric pressure.

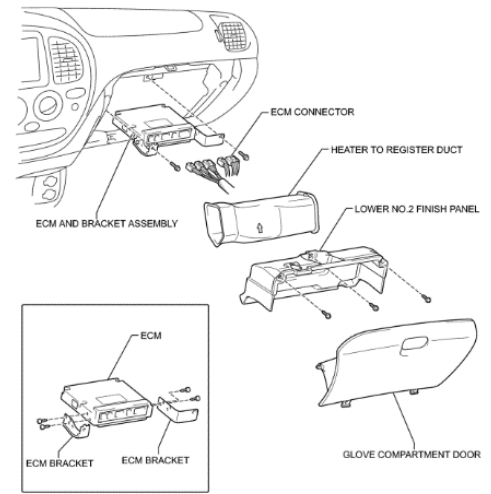

Figure 1 - ECM Location

- 1) Access the ECM located under the passenger side dash by removing the glove box as shown in Figure 1.
- 2) Disconnect Connector E7 as identified in Figure 2.
- 3) Remove any insulation cover from the wire bundle of Connector E7 to make it easier to separate and work on the individual wires.
- 4) Cut the **White/Blue** Wire of Pin 32 a couple of inches away from the connector. Strip the end of the cut **White/Blue** wire that comes from connector E7 and the **White** wire of the replacement pressure sensor and solder together to create a butt splice. Insulate the connection with electrical tape.
- 5) Insulate the cut end of the **White/Blue** wire that is coming from the wire bundle with electrical tape and leave disconnected. This effectively cuts loose the bad pressure sensor under the intake manifold.
- 6) Strip a small section of the **Green/Black** wire of Pin 23 without cutting the wire. Strip the end of the **Red** replacement sensor wire and wrap around the exposed section of **Green/Black** wire. Solder together to create a tap splice and insulate with electrical tape.
- 7) Strip a small section of the **Black/White** wire of Pin 28 without cutting the wire. Strip the end of the **Black** replacement sensor wire and wrap around the exposed section of **Black/White** wire. Solder together to create a tap splice and insulate with electrical tape.
- 8) Secure the sensor underneath the dash with a screw, electrical tape or zip ties so it is out of the way and stationary. Reconnect E7 to the ECM, clear the trouble codes and make sure the problem is resolved before reinstalling the glovebox.

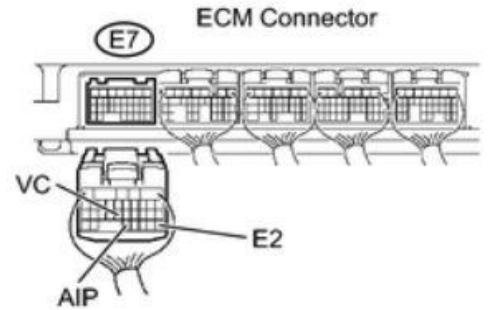

Figure 2 - ECM Connections

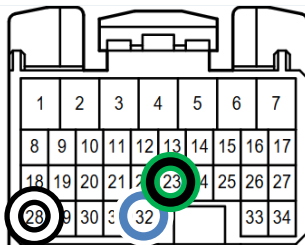

Figure 3 - Looking into the terminal side of connector E7 wire colors shown are coming out the back of the connector

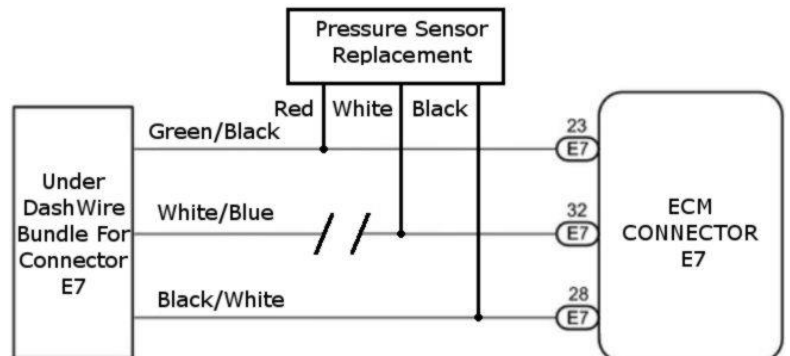

Figure 4 - Pressure Sensor Connection Diagram